

GMC-28 Touch Latch

Features

- No handle needed, just push to open / close
- Lightly push to open the door. When closing, arm will catch the counter plate and hold the door with a light push
- Passed 30,000 life cycle test

Notes

- For overlay door, make a 3 mm gap between door and cabinet frame

Parts Included

- Pan head wood screw 2.7×13
- Countersunk head wood screw 2.4×10

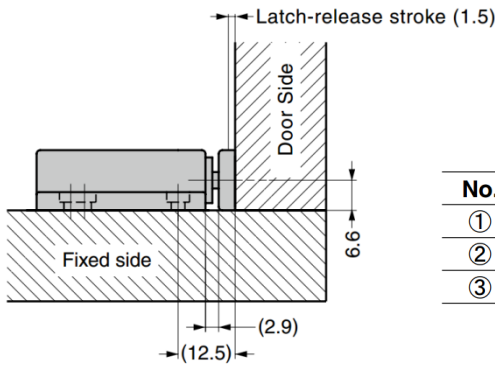

No.	Part Name	Material	Colour
①	Body	ABS	Black
②	Arm	POM	
③	Counter Plate	PA	

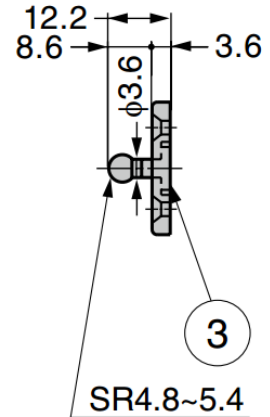
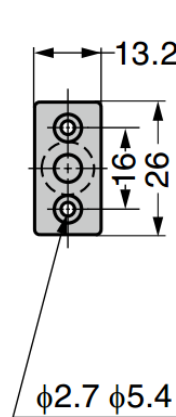
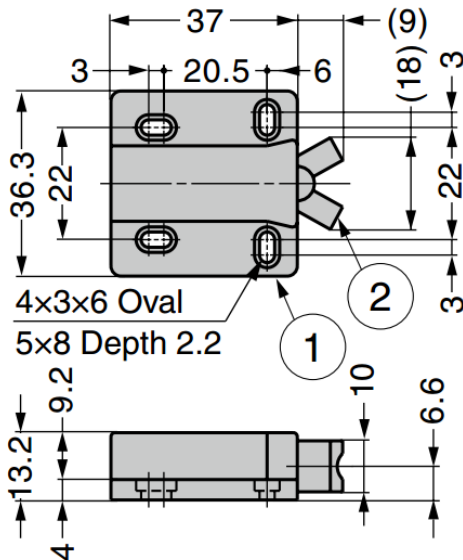

Part No.	Retaining Force	
GMC-28	29 N	3 kg